

IV.A. SUPPORTING DOCUMENTS

- i. Conceptual Design Floor Plans: Phase 1 & 2 Lower Level, Main Level, Upper Level
- ii. "Design Recommendations for a Library Listening Room"
- iii. "LEED v4.1 for Operations and Maintenance: Existing Buildings Scorecard"

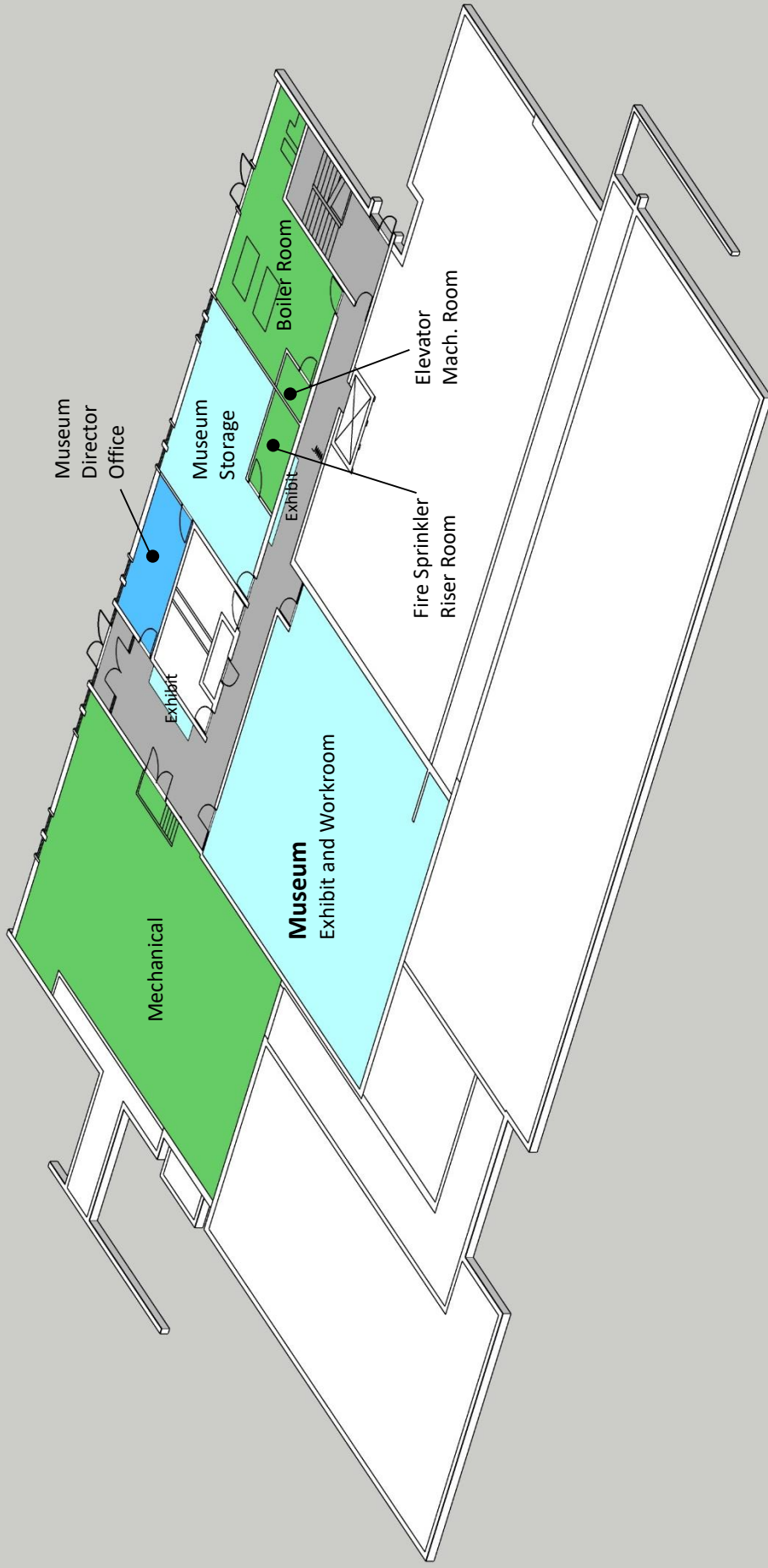



PROPOSED LOWER LEVEL Phase 1

2,596 ASF = 865 (Office) + 1,731 (General Use) + 2,476 (Support,

7,110 GSF / 2,476 (Some non-ASF Support)



PROPOSED LOWER LEVEL Phase 2

2,581 ASF = 399 (Classroom support) + 188 (Office) + 1,994 (Study)

7,110 GSF / 2,476 (Some non-ASF Support)

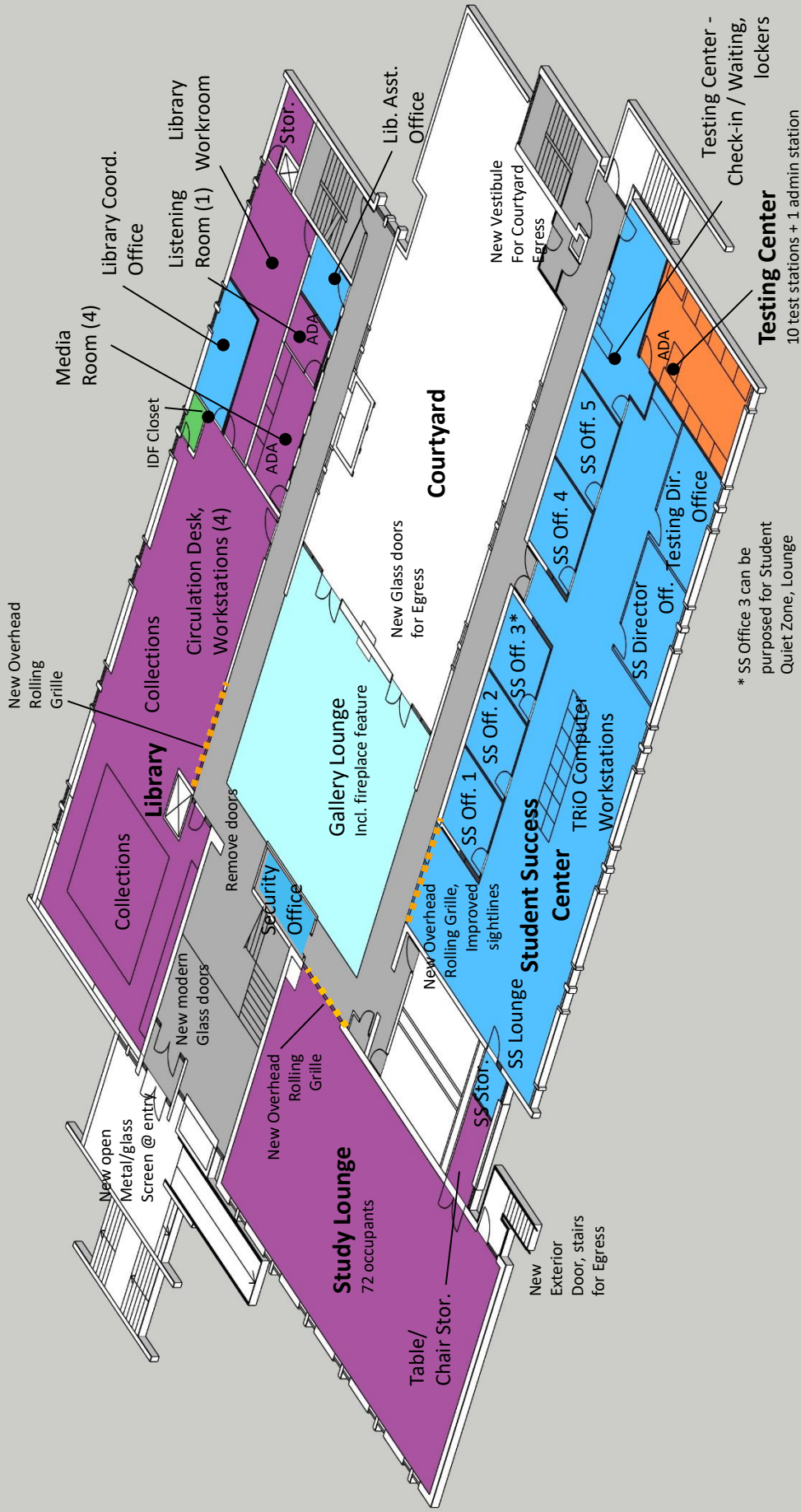

* SS Office 3 can be
purposed for Student
Quiet Zone, Lounge

Testing Center
10 test stations + 1 admin station

PROPOSED MAIN LEVEL

10,541 ASF = 356 (Teach. Laboratory) + 3,777 (Office) + 5,011 (Study) + 1,371 (General Use) + 26 (Support)
14,672 GSF

*Incubator Huddle Rooms can be purposed for Incubator Offices.

** The "new Seminar A" can be used by both the Incubator and Makerspace in addition to replacing a purposefully-sized conference room.

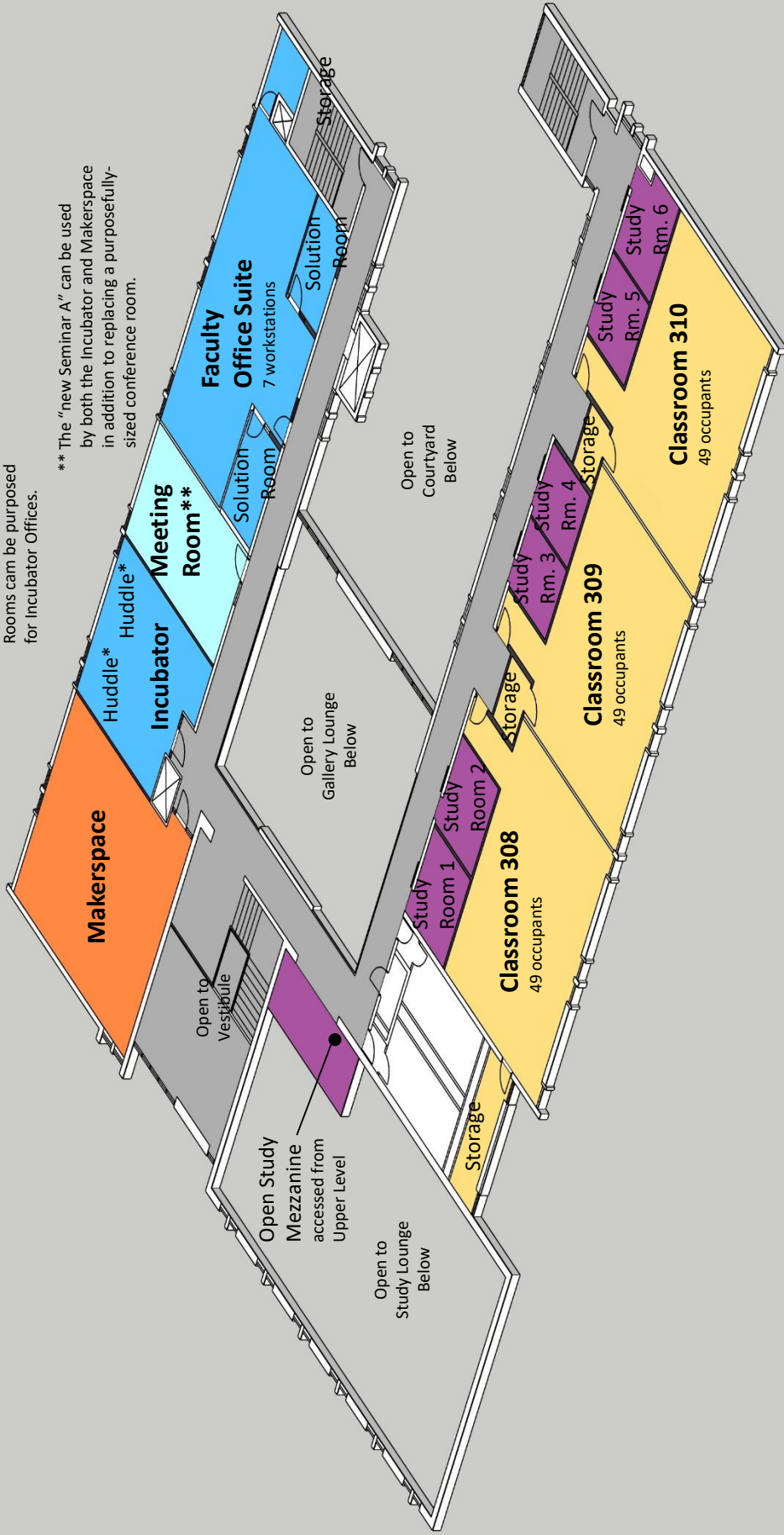

PROPOSED UPPER LEVEL

7,068 ASF = 3,156 (Classroom) + 923 (Open Teaching Laboratory)
 + 1,695 (Office) + 896 (Study) + 398 (Meeting Room)
 12,152 GSF

DESIGN RECOMMENDATIONS FOR A LIBRARY LISTENING ROOM

Prepared by Miles Hall

Turntable needs

Vinyl records were not formally introduced to the consumer market until 1948. Most recordings prior were made of shellac, for playback by a phonograph at 78rpm. There do exist a few recordings from the 1930s that were printed on vinyl and were intended for playback at 33rpm. However these are extremely rare, as they did not sell very well due to high overhead cost for playback during the great depression. Shellac records ended up being phased out of production by 1958. 1958 was also the year stereo records became available to the public.

Shellac records can be played on turntables, however it is important to bear in mind 2 things. The first is that the turntable can handle a playback speed of 78rpm. The second is that the grooves of shellac records are much larger than the '*microgroove*' format of vinyl records. Shellac grooves are about 3mm while vinyl grooves are about 0.6mm. As such, shellac records require a different stylus to play than vinyl records do.

With all this information in mind, and depending on the age-range of these recordings, specifically if there are any younger than 1948; I would suggest purchasing 2 turntables, one specifically for shellac recordings (you can call them 78s for shorthand), and one for vinyl. Should all the vinyl be pre-1958, you can go ahead and install a stylus specifically for monophonic playback. If not, one a stereophonic should be fine (no harm will come to the record), but with the expectation that a monophonic stylus will give playback with less noise.

The other option would be to instruct the attendant of this listening room as to the format needs and have them replace cartridges and styli for whatever the listening needs are, but this can be time-consuming and also because cartridges are rather fragile pieces of hardware, there will be much more wear than just regular listening usage and will have to be replaced more frequently.

The benefit of having 2 turntables is if the listener has both 78s and vinyl they would like to listen to they would be able to hear both kinds in a single listening session.

Stereo needs

There are many options available for amplifiers, honestly too many, and many of them can get very high in price range. Tube amplifiers are the obvious audiophile answer. When people refer to the *warmth* of tube amplifiers, what they are generally referring to is an increase of harmonic overtones which are created by pushing electricity through the vacuum tubes. I will attest there is a sonic difference between tube and standard solid-state amplifiers in favor of tubes, however to the average listener, this difference is almost negligible. And when coupled with the cost of tube amplifiers, especially for a 2 turntable setup (which will require purchasing at least 2) the overall price can really get up there.

I would suggest buying turntables with built-in preamps, so you can bypass the cost of expensive preamps, or have to find a receiver with 2 phono inputs. A standard receiver will be just fine, as its job is not to boost the volume of the turntable itself, but rather to boost the volume of the speakers. And unless you want to entrust the plugging and unplugging of the equipment to the listener, a receiver with an easy to use switch will be the most effective.

Gear Recommendation

For turntables, I would suggest an audio-technica LP-60XUSB for vinyl records and an Audio-Technica AT-LP120BK-USB with a VM670SP for 78s. For a receiver I would suggest a STRDH190. For speakers I would say a set of Klipsch R-41M would work well. With standard speaker wire the cost of all this would be around \$900.

The Space

This room would best be served by treatment as a sound booth. The most important aspect of it will be to keep outside noise to a minimum, but a secondary concern would be treatment of the space to allow playback to be faithfully experienced.

My suggestion for treatment of the interior is to have carpeting on the floor; smooth hard surfaces should certainly be kept to a minimum. The ceiling would also benefit greatly from some diffusion (for example https://www.supplyhouse.com/Hart-Cooley-50510-FPD308-Four-Way-Steel-Ceiling-Diffuser-8-Collar?gclid=Cj0KCQjwmdzzBRC7ARIsANdqRRIMGH3Wk8B0MWUTPFyJbH33bjNfrYwDc3xA TroI0YxmoWzC4ifWBGkaAvSAEALw_wcB), though this is not necessarily pertinent. The door and the walls to this space should be thick and potentially filled with a heavy non-porous material. Door seals would also be ideal (such as <https://www.soundproofcow.com/product/quiet-door-perimeter-seal/>) to keep any air between the room and the outside to an absolute minimum. If this is possible the only treatment really needed for the walls would be some acoustic panels just to keep the room from being too reverberant.

In previous discussions we had spoken of a window, so that the people inside the listening space would not be entirely disconnected from the outside. Given the layout sent to me in your notes, I would suggest the window be no more than 2' adjacent to the door frame. You could potentially utilize some textured glass to act to sound diffusion, or purchase diffusion windows (<http://arithmetic-design.com/diffuse-glass/>) but you would probably be fine with just keeping the window visible to the outside but also a minimum of actual surface area along the wall. Keep in mind the thinner the glass, the more noise from the outside can be let in.

In order to fit both a stereo receiver and 2 turntables on the space, I'll suggest for the desk to take up the entirety of the back wall, and come out 2'-6", allowing a 7'x7' space for the listener. This gives desk space for laptops, music scores, etc. around 11.25sf which should be enough to work with, provided one of the turntables lives on top of the receiver which is common. The other option would be to store the receiver in a rack on the side of the desk. This could free up more desk space.

The speakers could potentially also be kept on the desk, but may be better served by being mounted on the wall slightly above the desk. This not only frees up desk space, but allows the speaker cone to also live at ear-level of the listener. The advantage of this is that the sound of the speakers also won't create some unwanted resonance with the rest of the room, from vibrating against the desk. The speakers should also be angled inward, to face the listener directly.

Sources and further reading

Mudge, S., D.J. Hoek. *Describing jazz, blues, and popular 78 RPM sound recordings: suggestions and guidelines*. *Cataloging & Classification Quarterly*, vo. 29, no. 3, 2001, p. 21-48.

<https://www.projectaudio.com.au/blogs/vinyl-life-blog/how-to-play-78s>

<https://blog.audio-technica.com/audio-solutions-question-of-the-week-what-cartridges-and-styles-does-audio-technica-offer-for-playing-78-rpm-records/>

Rossing, Thomas D., 1929-/.
The science of sound.-3rd ed. / Thomas D. Rossing, Paul Wheeler, and Richard Moore.1



LEED v4.1 for Operations & Maintenance: Existing Buildings
Scorecard

Y ? N

0	0	0	Location and Transportation	14
6			Prereq Transportation Performance	14

0	0	0	Sustainable Sites	4
			Credit Rainwater Management	1
			Credit Heat Island Reduction	1
			Credit Light Pollution Reduction	1
			Credit Site Management	1

0	0	0	Water Efficiency	15
6			Prereq Water Performance	15

0	0	0	Energy and Atmosphere	35
Y			Prereq Energy Efficiency Best Management Practices	Required
Y			Prereq Fundamental Refrigerant Management	Required
13			Prereq Energy Performance	33
			Credit Enhanced Refrigerant Management	1
			Credit Grid Harmonization	1

0	0	0	Materials and Resources	9
Y			Prereq Purchasing Policy	Required
Y			Prereq Facility Maintenance and Renovations Policy	Required
3			Prereq Waste Performance	8
			Credit Purchasing	1

0	0	0	Indoor Environmental Quality	22
Y			Prereq Minimum Indoor Air Quality	Required
Y			Prereq Environmental Tobacco Smoke Control	Required
Y			Prereq Green Cleaning Policy	Required
8			Prereq Indoor Environmental Quality Performance	20
			Credit Green Cleaning	1
			Credit Integrated Pest Management	1

0	0	0	Innovation	1
			Credit Innovation	1

0	0	0	TOTALS	Possible Points: 100
---	---	---	---------------	-----------------------------

Certified: 40-49 points, **Silver:** 50-59 points, **Gold:** 60-79 points, **Platinum:** 80+

IV.B. ROOM UTILIZATION

i. Classroom Utilization Analysis – Detail for Fall 2019, SmithGroup.



Trinidad State Junior College Classroom Utilization

There are 19 general purpose classrooms on the Trinidad State Junior College campus. They are scheduled, on average, 12 hours per week. When a room is scheduled, on average, 43% of the student stations (seats) are occupied. This is lower than the typical utilization expectation for a community college of 30 hours per week with 65% of the stations occupied, indicating a surplus in classroom capacity at TSJC.

The following chart lists all general purpose classrooms on campus. Included is the number of student stations in the room, the average enrollment of the course sections taught in the room, the hours per week the room is scheduled, and the percentage of seats occupied when the room is scheduled.

Also included is the number of weekly seat hours, which is a measure of the number of hours per week each classroom seat is occupied. The typical expectation at a community college is 19.5 weekly seat hours campus wide.

Classroom Utilization Analysis by Building

Fall 2019

Room ID	Space Use Code	Assignable Sq. Ft.	No. of Stations	Assignable Sq. Ft. Per Station	Average Enrollment	Weekly Student Contact Hours	Weekly Seat Hours	Weekly Room Hours	Hours in Use Student Station Occupancy %
BERG									<i>No. of Rooms = 7</i>
BERG 105	110	0	66	0	21	501	7.6	24	32%
BERG 301	110	0	10	0	4	15	1.5	8	20%
BERG 304	110	0	24	0	16	276	11.5	17	70%
BERG 305	110	0	19	0	16	96	5.1	6	84%
BERG 307	110	0	20	0	13	93	4.7	8	62%
BERG 309	110	0	48	0	13	93	1.9	8	26%
BERG 310	110	0	38	0	14	162	4.3	12	36%
Average			32	.0 *	14		5.5	12	45%
Total			225			1,236		81	
DAVIS									<i>No. of Rooms = 7</i>
DAVIS 105	110	0	32	0	2	6	0.2	3	6%
DAVIS 115	110	0	25	0	11	144	5.8	13	44%
DAVIS 123	110	0	20	0	16	281	14.1	17	83%
DAVIS 133	110	0	24	0	10	138	5.8	15	40%
DAVIS 146	110	0	18	0	18	54	3.0	3	100%
DAVIS 203A	110	0	24	0	12	266	11.1	22	50%
DAVIS 215	110	0	24	0	9	276	11.5	29	40%
Average			24	.0 *	11		7.0	14	51%
Total			167			1,165		101	
LIB									<i>No. of Rooms = 5</i>
LIB 308	110	0	44	0	10	131	3.0	14	22%
LIB 309A	110	0	24	0	7	95	3.9	15	26%
LIB 309B	110	0	20	0	6	33	1.7	6	27%
LIB 310	110	0	32	0	2	10	0.3	6	5%
LIB 312	110	0	16	0	6	67	4.2	13	32%
Average			27	.0 *	6		2.5	11	24%
Total			136			335		54	
AVERAGE			28	.0 *	11		5.2	12	43%
TOTAL			528			2,736		236	
NO. OF ROOMS		19							

At any point in time, no more than 10 classrooms are scheduled. The highest scheduled use is on Monday and Wednesday at 1:00 and on Tuesday at 11:00. Occasionally a campus has low overall utilization but “crunch” times when every teaching on campus is in use, requiring a change in scheduling policy to increase utilization. This is not the case at TSJC.

Scheduled Classroom Use by Day and Time (Fall 2019)

Time of Day	Monday		Tuesday		Wednesday		Thursday		Friday		Average	
	Rooms in Use	% In Use	Rooms in Use	% In Use	Rooms in Use	% In Use	Rooms in Use	% In Use	Rooms in Use	% In Use	Rooms in Use	% In Use
8:00 AM	6	32%	6	32%	7	37%	4	21%	1	5%	5	25%
8:30 AM	6	32%	6	32%	7	37%	4	21%	1	5%	5	25%
9:00 AM	5	26%	6	32%	6	32%	3	16%	1	5%	4	22%
9:30 AM	7	37%	9	47%	5	26%	7	37%	1	5%	6	31%
10:00 AM	7	37%	9	47%	5	26%	7	37%	1	5%	6	31%
10:30 AM	7	37%	9	47%	5	26%	7	37%	1	5%	6	31%
11:00 AM	6	32%	10	53%	4	21%	7	37%	0	0%	5	28%
11:30 AM	6	32%	10	53%	4	21%	7	37%	0	0%	5	28%
12:00 PM	4	21%	8	42%	4	21%	7	37%	0	0%	5	24%
12:30 PM	7	37%	9	47%	8	42%	7	37%	0	0%	6	33%
1:00 PM	10	53%	9	47%	10	53%	6	32%	0	0%	7	37%
1:30 PM	10	53%	8	42%	10	53%	6	32%	0	0%	7	36%
2:00 PM	4	21%	3	16%	3	16%	3	16%	0	0%	3	14%
2:30 PM	2	11%	3	16%	2	11%	3	16%	0	0%	2	11%
3:00 PM	1	5%	2	11%	1	5%	3	16%	0	0%	1	7%
3:30 PM	0	0%	4	21%	0	0%	5	26%	0	0%	2	9%
4:00 PM	1	5%	5	26%	2	11%	5	26%	0	0%	3	14%
4:30 PM	2	11%	6	32%	3	16%	5	26%	0	0%	3	17%
5:00 PM	2	11%	4	21%	3	16%	2	11%	0	0%	2	12%
5:30 PM	2	11%	3	16%	3	16%	2	11%	0	0%	2	11%
6:00 PM	3	16%	3	16%	4	21%	2	11%	0	0%	2	13%
6:30 PM	2	11%	1	5%	3	16%	1	5%	0	0%	1	7%
7:00 PM	2	11%	1	5%	3	16%	1	5%	0	0%	1	7%

Total classrooms = 19

(Darker colors indicate a large percentage of rooms are scheduled.)

Freudenthal Hall has five classrooms. Four are scheduled at 1:00 on Monday and Wednesday. Three are scheduled from 8:00 to 9:30 on Monday and Wednesday. There is very little scheduled use of the classrooms in Freudenthal at other times.

Scheduled Classroom Use by Day and Time (Fall 2019)

Time of Day	Monday		Tuesday		Wednesday		Thursday		Friday		Average	
	Rooms in Use	% In Use	Rooms in Use	% In Use	Rooms in Use	% In Use	Rooms in Use	% In Use	Rooms in Use	% In Use	Rooms in Use	% In Use
8:00 AM	3	60%	2	40%	3	60%	0	0%	0	0%	2	32%
8:30 AM	3	60%	2	40%	3	60%	0	0%	0	0%	2	32%
9:00 AM	3	60%	2	40%	3	60%	0	0%	0	0%	2	32%
9:30 AM	1	20%	2	40%	1	20%	1	20%	0	0%	1	20%
10:00 AM	1	20%	2	40%	1	20%	1	20%	0	0%	1	20%
10:30 AM	1	20%	2	40%	1	20%	1	20%	0	0%	1	20%
11:00 AM	1	20%	2	40%	1	20%	1	20%	0	0%	1	20%
11:30 AM	1	20%	2	40%	1	20%	1	20%	0	0%	1	20%
12:00 PM	1	20%	2	40%	1	20%	1	20%	0	0%	1	20%
12:30 PM	2	40%	2	40%	2	40%	1	20%	0	0%	1	28%
1:00 PM	4	80%	2	40%	4	80%	1	20%	0	0%	2	44%
1:30 PM	4	80%	2	40%	4	80%	1	20%	0	0%	2	44%
2:00 PM	2	40%	0	0%	2	40%	0	0%	0	0%	1	16%
2:30 PM	1	20%	0	0%	1	20%	0	0%	0	0%	0	8%
3:00 PM	0	0%	0	0%	0	0%	0	0%	0	0%	0	0%
3:30 PM	0	0%	0	0%	0	0%	1	20%	0	0%	0	4%
4:00 PM	0	0%	0	0%	0	0%	1	20%	0	0%	0	4%
4:30 PM	1	20%	1	20%	1	20%	1	20%	0	0%	1	16%
5:00 PM	1	20%	1	20%	1	20%	0	0%	0	0%	1	12%
5:30 PM	1	20%	1	20%	1	20%	0	0%	0	0%	1	12%
6:00 PM	1	20%	1	20%	2	40%	0	0%	0	0%	1	16%
6:30 PM	0	0%	0	0%	1	20%	0	0%	0	0%	0	4%
7:00 PM	0	0%	0	0%	1	20%	0	0%	0	0%	0	4%

Total classrooms = 5

(Darker colors indicate a large percentage of rooms are scheduled.)

IV.C. ROOM DATA SHEETS

The following details design requirements per specific programmed space.

Source: Hall Architects.



Photo source: Loudon-Henritze Museum.

Space Number	1.01
Space Name	Academic Storage (Lower Level)
Quantity	1
Unit Area	399 asf
Area	399 asf
Occupancy	B
Occupants	N/A
Description	Classroom Storage
Uses	Storage
Adjacencies	Elevator
Furniture	N/A
Moveable Equipment	N/A
Fixed Equipment	N/A
Doors	Lockset reader
Windows	Shades
Floor	Resilient flooring
Walls	Gypsum board, low VOC paint, sound batt insulation
Ceiling	Grid / ACT
Acoustics	CAC: 35 minimum / NRC: 0.65 minimum
HVAC	LEED – independent zone
Plumbing	None
Power	110 V, 20 amp
Lighting	LED
Audio/Visual	None
Data	Wireless
Telephone	No
Security	Lockset reader
Life Safety	NFPA fire sprinkler
Environmental Quality	Low-Emitting Materials

Space Number	1.02 (308)
Space Name	Large General Purpose Classroom, Business
Quantity	1
Unit Area	984 asf
Area	984 asf
Occupancy	B
Occupants	34 – 38 (one required exit)
Description	Classroom
Uses	Lecture room, storage
Adjacencies	Classrooms, Study Rooms, Restrooms
Furniture	Chairs, tables (mobile versions)
Moveable Equipment	Podium, other TBD
Fixed Equipment	Marker boards (white, glass), projection screen
Doors	Lock, glazing (narrow lite)
Windows	Insulated, low-E glazing, shades
Floor	Resilient flooring
Walls	Gypsum board, low VOC paint, sound batt insulation
Ceiling	Grid / ACT
Acoustics	STC: 50; NRC: 0.70 min.
HVAC	LEED – independent zone
Plumbing	none
Power	110 V, 20 amp
Lighting	LED
Audio/Visual	Digital projector
Data	Data outlets, wireless
Telephone	Yes
Security	Lock
Life Safety	NFPA fire sprinkler
Environmental Quality	Low-Emitting Materials, Lighting Controls, Exterior glazing

Space Number	1.03 (309)
Space Name	Large General Purpose Classroom
Quantity	1
Unit Area	981 asf
Area	981 asf
Occupancy	B
Occupants	34 – 38 (one required exit)
Description	Classroom
Uses	Lecture room, storage
Adjacencies	Classrooms, Study Rooms, Restrooms
Furniture	Chairs, tables (mobile versions)
Moveable Equipment	Podium, other TBD
Fixed Equipment	Marker boards (white, glass), projection screen
Doors	Lock, glazing (narrow lite)
Windows	Insulated, low-E glazing, shades
Floor	Resilient flooring
Walls	Gypsum board, low VOC paint, sound batt insulation
Ceiling	Grid / ACT
Acoustics	STC: 50; CAC: 35 min. / NRC: 0.70 min.
HVAC	LEED – independent zone
Plumbing	none
Power	110 V, 20 amp
Lighting	Fluorescent
Audio/Visual	Digital projector
Data	Data outlets, wireless
Telephone	Yes
Security	Lock
Life Safety	NFPA fire sprinkler
Environmental Quality	Low-Emitting Materials, Lighting Controls, Exterior glazing

Space Number	1.04 (310)
Space Name	Large General Purpose Classroom
Quantity	1
Unit Area	984 asf
Area	984 asf
Occupancy	B
Occupants	34 - 38 (one required exit)
Description	Classroom
Uses	Lecture room, storage
Adjacencies	Classrooms, Study Rooms, Restrooms
Furniture	Chairs, tables (mobile versions)
Moveable Equipment	Podium
Fixed Equipment	Marker boards (white, glass), projection screen
Doors	Lock, glazing (narrow lite)
Windows	Insulated, low-E glazing, shades
Floor	Resilient flooring
Walls	Gypsum board, low VOC paint, sound batt insulation
Ceiling	Grid / ACT
Acoustics	STC: 50; NRC: 0.70 min.
HVAC	LEED – independent zone
Plumbing	none
Power	110 V, 20 amp
Lighting	Fluorescent
Audio/Visual	Digital projector, video teleconferencing
Data	Data outlets, wireless, video teleconferencing
Telephone	Yes
Security	Lock
Life Safety	NFPA fire sprinkler
Environmental Quality	Low-Emitting Materials, Lighting Controls, Exterior glazing

Space Number	1.05 (308A)
Space Name	Classroom Storage
Quantity	1
Unit Area	113 asf
Area	113 asf
Occupancy	B
Occupants	N/A
Description	Classroom Storage
Uses	Storage
Adjacencies	Classroom
Furniture	N/A
Moveable Equipment	N/A
Fixed Equipment	N/A
Doors	Lock
Windows	Insulated, low-E glazing, shades
Floor	Resilient flooring
Walls	Gypsum board, low VOC paint, sound batt insulation
Ceiling	Grid / ACT
Acoustics	CAC: 35 minimum / NRC: 0.65 minimum
HVAC	LEED – independent zone
Plumbing	None
Power	110 V, 20 amp
Lighting	LED
Audio/Visual	None
Data	Wireless
Telephone	No
Security	Lock
Life Safety	NFPA fire sprinkler
Environmental Quality	Low-Emitting Materials, Lighting Controls, Exterior glazing

Space Number	1.06 (309 A)
Space Name	Classroom Storage
Quantity	1
Unit Area	48 asf
Area	48 asf
Occupancy	B
Occupants	N/A
Description	Classroom Storage
Uses	Storage
Adjacencies	Classroom
Furniture	N/A
Moveable Equipment	N/A
Fixed Equipment	N/A
Doors	Lock
Windows	N/A
Floor	Resilient flooring
Walls	Gypsum board, low VOC paint, sound batt insulation
Ceiling	Grid / ACT
Acoustics	STC: 40; CAC: 35 min. / NRC: 0.65 min.
HVAC	LEED – independent zone
Plumbing	None
Power	110 V, 20 amp
Lighting	LED
Audio/Visual	None
Data	None
Telephone	None
Security	Lock
Life Safety	NFPA fire sprinkler
Environmental Quality	Low-Emitting Materials

Space Number	1.07 (310A)
Space Name	Classroom Storage
Quantity	1
Unit Area	46 asf
Area	46 asf
Occupancy	B
Occupants	N/A
Description	Classroom Storage
Uses	Storage
Adjacencies	Classroom
Furniture	N/A
Moveable Equipment	N/A
Fixed Equipment	N/A
Doors	Lock
Windows	N/A
Floor	Resilient flooring
Walls	Gypsum board, low VOC paint, sound batt insulation
Ceiling	Grid / ACT
Acoustics	STC: 40 min.; CAC: 0.35 min. / NRC: 0.65 min.
HVAC	LEED – independent zone
Plumbing	None
Power	110 V, 20 amp
Lighting	LED
Audio/Visual	None
Data	Wireless
Telephone	None
Security	Lock
Life Safety	NFPA fire sprinkler
Environmental Quality	Low-Emitting Materials

Space Number	2.01
Space Name	Testing Center Exam Room
Quantity	1
Unit Area	356 asf
Area	356 asf
Occupancy	B
Occupants	11 = 10 test stations + 1 administrator station
Description	Testing Center Exam Room
Uses	Testing, proctoring
Adjacencies	Testing Center Check-in/Wait Room, Testing Center Director Office, Student Success Center, Restrooms
Furniture	Chairs, carrel desks
Moveable Equipment	Computers, monitors
Fixed Equipment	Surveillance cameras
Doors	Lock, glazing (narrow lite), dedicated entrance
Windows	Interior one-way, soundproof windows
Floor	Carpet tile
Walls	Gypsum board, low VOC paint, sound batt insulation
Ceiling	Grid / ACT
Acoustics	STC: 50; CAC: 35 min. / NRC: 0.65 min.
HVAC	LEED – ind. Zone; Pearson VUE testing facility recommendations
Plumbing	None
Power	110 V, 20 amp
Lighting	LED, Pearson VUE testing facility recommendations
Audio/Visual	Live feed video surveillance cameras (inside and outside exam room)
Data	Data outlets, wireless
Telephone	None
Security	Lock
Life Safety	NFPA fire sprinkler
Environmental Quality	Low-Emitting Materials, Lighting Controls

Space Number	2.02
Space Name	Makerspace
Quantity	1
Unit Area	923 asf
Area	923 asf
Occupancy	B
Occupants	30
Description	Makerspace
Uses	Makerspace, Open Teaching Lab, Club meeting space
Adjacencies	TSJC Business Incubator, Meeting Room
Furniture	Chairs, tables, desks (mobile)
Moveable Equipment	3D printer(s) with UPS, plotter/scanner, other TBD
Fixed Equipment	Casework (lockable), lockers
Doors	Lockset reader, glazing (narrow lite)
Windows	Insulated, low-E glazing, shades
Floor	Static-dissipative flooring, carpet tiles
Walls	Gypsum board, low VOC paint, sound batt insulation, acoustic panels
Ceiling	Grid / ACT
Acoustics	CAC: 35 minimum / NRC: 0.65 minimum
HVAC	LEED – independent zone
Plumbing	None
Power	110 V, 20 amp / PSU 240V, output 12 V up to 30 amp; overhead extension cords
Lighting	LED overhead, task lighting
Audio/Visual	Digital projector
Data	Data outlets, wireless
Telephone	Yes
Security	Lockset reader
Life Safety	NFPA fire sprinkler
Environmental Quality	Low-Emitting Materials, Lighting Controls

Space Number	3.01
Space Name	Archivist Office
Quantity	1
Unit Area	188 asf
Area	188 asf
Occupancy	B
Occupants	1
Description	Archivist Office
Uses	Office
Adjacencies	Research/Resource Collaborative Workroom, Conservation Workroom, Archives
Furniture	Chairs, desk, filing cabinets, bookcases, whiteboards
Moveable Equipment	Computer, monitor, other TBD
Fixed Equipment	Cabinets
Doors	Lockset reader, glazing (narrow lite)
Windows	Insulated, low-e glass, shades
Floor	Carpet tile
Walls	Gypsum board, low VOC paint, sound batt insulation
Ceiling	Grid / ACT
Acoustics	CAC: 35 minimum / NRC: 0.65 minimum
HVAC	LEED – independent zone
Plumbing	None
Power	110 V, 20 amp
Lighting	LED
Audio/Visual	TBD
Data	Data outlets, wireless
Telephone	Yes
Security	Lock
Life Safety	NFPA fire sprinkler
Environmental Quality	Low-Emitting Materials, Lighting Controls

Space Number	3.02
Space Name	Library Coordinator / Director Office
Quantity	1
Unit Area	160 asf
Area	160 asf
Occupancy	B
Occupants	1
Description	Library Coordinator / Director Office
Uses	Office
Adjacencies	Library Collections, Circulation, Workroom
Furniture	Chairs, desk, filing cabinets, bookcases
Moveable Equipment	Computer, monitor, printer
Fixed Equipment	Whiteboards
Doors	Lockset reader, glazing (narrow lite)
Windows	Insulated, low-E glazing, shades
Floor	Carpet tile
Walls	Gypsum board, low VOC paint, sound batt insulation
Ceiling	Grid / ACT
Acoustics	CAC: 35 minimum / NRC: 0.65 minimum
HVAC	LEED – independent zone
Plumbing	None
Power	110 V, 20 amp
Lighting	LED
Audio/Visual	Monitor
Data	Data outlets, wireless
Telephone	Yes
Security	Lock
Life Safety	NFPA fire sprinkler
Environmental Quality	Low-Emitting Materials, Lighting Controls

Space Number	3.03
Space Name	Library Assistant Office
Quantity	1
Unit Area	79 asf
Area	79 asf
Occupancy	B
Occupants	1
Description	Library Assistant Office
Uses	Office
Adjacencies	Library Collections, Circulation, Workroom
Furniture	Chairs, desk, filing cabinets, bookcase
Moveable Equipment	Computer, monitor
Fixed Equipment	Whiteboard
Doors	Lockset reader, glazing (narrow lite)
Windows	Insulated, low-e glass, shades
Floor	Carpet tile
Walls	Gypsum board, low VOC paint, sound batt insulation
Ceiling	Grid / ACT
Acoustics	CAC: 35 minimum / NRC: 0.65 minimum
HVAC	LEED – independent zone
Plumbing	None
Power	110 V, 20 amp
Lighting	LED
Audio/Visual	TBD
Data	Data outlets, wireless
Telephone	Yes
Security	Lock
Life Safety	NFPA fire sprinkler
Environmental Quality	Low-Emitting Materials, Lighting Controls

Space Number	3.04
Space Name	Security Office
Quantity	1
Unit Area	91 asf
Area	91 asf
Occupancy	B
Occupants	1
Description	Security Office
Uses	Office
Adjacencies	Main entrance, Library Circulation, Study Lounge
Furniture	Chairs, desk, filing cabinets, bookcase
Moveable Equipment	Computer, monitors
Fixed Equipment	Whiteboard
Doors	Lockset reader
Windows	TBD
Floor	Carpet tile
Walls	Gypsum board, low VOC paint, sound batt insulation
Ceiling	Grid / ACT
Acoustics	CAC: 35 minimum / NRC: 0.65 minimum
HVAC	LEED – independent zone
Plumbing	None
Power	110 V, 20 amp
Lighting	LED
Audio/Visual	Video surveillance monitors
Data	Data outlets, wireless
Telephone	Yes
Security	Lockset reader
Life Safety	NFPA fire sprinkler
Environmental Quality	Low-Emitting Materials, Lighting Controls

Space Number	3.05
Space Name	SSC Director Office
Quantity	1
Unit Area	165 asf
Area	165 asf
Occupancy	B
Occupants	1
Description	SSC Director Office
Uses	Office
Adjacencies	SSC Offices, SSC Lounge, SSC TRiO Workstations, Testing Center, Restrooms
Furniture	Chairs, desk, filing cabinets, bookcases
Moveable Equipment	Computer, monitor
Fixed Equipment	Whiteboard
Doors	Lock, glazing (narrow lite)
Windows	Insulated, low e-glazing, shades
Floor	Carpet tile
Walls	Gypsum board, low VOC paint, sound batt insulation
Ceiling	Grid / ACT
Acoustics	STC: 40; CAC: 35 min. / NRC: 0.65 min.
HVAC	LEED – independent zone
Plumbing	None
Power	110 V, 20 amp
Lighting	LED
Audio/Visual	None
Data	Data outlets, wireless
Telephone	Yes
Security	Lock
Life Safety	NFPA fire sprinkler
Environmental Quality	Low-Emitting Materials, Lighting Controls

Space Number	3.06
Space Name	Academic Coordinator Office
Quantity	1
Unit Area	144 asf
Area	144 asf
Occupancy	B
Occupants	1
Description	Academic Coordinator Office
Uses	Office
Adjacencies	SSC Offices, SSC Lounge, SSC TRiO Workstations, Testing Center, Restrooms
Furniture	Chairs, desk, filing cabinets, bookcases
Moveable Equipment	Computer, monitor
Fixed Equipment	Whiteboard
Doors	Lockset reader, glazing (narrow lite)
Windows	Shades
Floor	Carpet tile
Walls	Gypsum board, low VOC paint, sound batt insulation
Ceiling	Grid / ACT
Acoustics	STC: 40; CAC: 35 min. / NRC: 0.65 min.
HVAC	LEED – independent zone
Plumbing	None
Power	110 V, 20 amp
Lighting	LED
Audio/Visual	None
Data	Data outlets, wireless
Telephone	Yes
Security	Lock
Life Safety	NFPA fire sprinkler
Environmental Quality	Low-Emitting Materials, Lighting Controls

Space Number	3.07
Space Name	Disabilities Coordinator/CTE Advisor Office
Quantity	1
Unit Area	146 asf
Area	146 asf
Occupancy	B
Occupants	1
Description	Disabilities Coordinator/CTE Advisor Office
Uses	Office
Adjacencies	SSC Offices, SSC Lounge, SSC TRiO Workstations, Testing Center, Restrooms
Furniture	Chairs, desk, filing cabinets, bookcases
Moveable Equipment	Computer, monitor
Fixed Equipment	Whiteboard
Doors	Lockset reader, glazing (narrow lite)
Windows	Shades
Floor	Carpet tile
Walls	Gypsum board, low VOC paint, sound batt insulation
Ceiling	Grid / ACT
Acoustics	STC: 40; CAC: 35 min. / NRC: 0.65 min.
HVAC	LEED – independent zone
Plumbing	None
Power	110 V, 20 amp
Lighting	LED
Audio/Visual	None
Data	Data outlets, wireless
Telephone	Yes
Security	Lock
Life Safety	NFPA fire sprinkler
Environmental Quality	Low-Emitting Materials, Lighting Controls

Space Number	3.08
Space Name	Transfer Coordinator Office
Quantity	1
Unit Area	130 asf
Area	130 asf
Occupancy	B
Occupants	1
Description	Transfer Coordinator Office
Uses	Office
Adjacencies	SSC Offices, SSC Lounge, SSC TRiO Workstations, Testing Center, Restrooms
Furniture	Chairs, desk, filing cabinets, bookcases
Moveable Equipment	N/A
Fixed Equipment	Whiteboard
Doors	Lockset reader, glazing (narrow lite)
Windows	Shades
Floor	Carpet tile
Walls	Gypsum board, low VOC paint, sound batt insulation
Ceiling	Grid / ACT
Acoustics	STC: 40; CAC: 35 min. / NRC: 0.65 min.
HVAC	LEED – independent zone
Plumbing	None
Power	110 V, 20 amp
Lighting	LED
Audio/Visual	None
Data	Data outlets, wireless
Telephone	Yes
Security	Lock
Life Safety	NFPA fire sprinkler
Environmental Quality	Low-Emitting Materials, Lighting Controls

Space Number	3.09
Space Name	Upward Bound Coordinator Office
Quantity	1
Unit Area	130 asf
Area	130 asf
Occupancy	B
Occupants	1
Description	Upward Bound Coordinator Office
Uses	Office
Adjacencies	SSC Offices, SSC Lounge, SSC TRiO Workstations, Testing Center, Restrooms
Furniture	Chairs, desk, filing cabinets, bookcases
Moveable Equipment	N/A
Fixed Equipment	Whiteboard
Doors	Lockset reader, glazing (narrow lite)
Windows	Shades
Floor	Carpet tile
Walls	Gypsum board, low VOC paint, sound batt insulation
Ceiling	Grid / ACT
Acoustics	STC: 40; CAC: 35 min. / NRC: 0.65 min.
HVAC	LEED – independent zone
Plumbing	None
Power	110 V, 20 amp
Lighting	LED
Audio/Visual	None
Data	Data outlets, wireless
Telephone	Yes
Security	Lock
Life Safety	NFPA fire sprinkler
Environmental Quality	Low-Emitting Materials, Lighting Controls

Space Number	3.10
Space Name	Future SSC Office
Quantity	1
Unit Area	130 asf
Area	130 asf
Occupancy	B
Occupants	1
Description	Future SSC Office
Uses	Student Service Office; can be used as a staff resource/lounge area
Adjacencies	SSC Offices, SSC Lounge, SSC TRiO Workstations, Testing Center, Restrooms
Furniture	Chairs, desk, filing cabinets, bookcases
Moveable Equipment	N/A
Fixed Equipment	Whiteboard
Doors	Lockset reader, glazing (narrow lite)
Windows	Shades
Floor	Carpet tile
Walls	Gypsum board, low VOC paint, sound batt insulation
Ceiling	Grid / ACT
Acoustics	STC: 40; CAC: 35 min. / NRC: 0.65 min.
HVAC	LEED – independent zone
Plumbing	None
Power	110 V, 20 amp
Lighting	LED
Audio/Visual	None
Data	Data outlets, wireless
Telephone	Yes
Security	Lock
Life Safety	NFPA fire sprinkler
Environmental Quality	Low-Emitting Materials, Lighting Controls

Space Number	3.11
Space Name	Student Success Center Lounge
Quantity	1
Unit Area	1958 asf
Area	1958 asf
Occupancy	B
Occupants	13
Description	Student Success Center Lounge
Uses	Study, Tutor sessions, workshops
Adjacencies	SS Offices, TRiO workstations, restrooms
Furniture	Chairs, tables
Moveable Equipment	Mobile whiteboards, glassboards
Fixed Equipment	N/A
Doors	Overhead grille door
Windows	Insulated, low e-glazing, window film
Floor	Carpet tile
Walls	Gypsum board, low VOC paint, sound batt insulation, wall protection
Ceiling	Grid / ACT
Acoustics	STC: 40; NRC: 0.80 min.
HVAC	LEED – independent zone
Plumbing	None
Power	110 V, 20 amp
Lighting	LED
Audio/Visual	None
Data	Wireless
Telephone	None
Security	N/A
Life Safety	NFPA fire sprinkler
Environmental Quality	Low-Emitting Materials

Space Number	3.12
Space Name	Student Success Center Work Study stations
Quantity	4
Unit Area	25 asf
Area	100 asf
Occupancy	B
Occupants	4
Description	Student Success Center Work Study stations
Uses	Reception, Office
Adjacencies	SSC Offices, SSC Lounge, SSC TRiO Workstations, Testing Center, Restrooms
Furniture	Chairs, desks
Moveable Equipment	Whiteboard /Glass board
Fixed Equipment	N/A
Doors	N/A
Windows	N/A
Floor	Carpet tile
Walls	Gypsum board, low VOC paint, sound batt insulation
Ceiling	Grid / ACT
Acoustics	NRC: 0.80 min.
HVAC	LEED – independent zone
Plumbing	None
Power	110 V, 20 amp
Lighting	LED
Audio/Visual	None
Data	Wireless, other TBD
Telephone	TBD
Security	N/A
Life Safety	NFPA fire sprinkler
Environmental Quality	Low-Emitting Materials, Lighting Controls

Space Number	3.13
Space Name	TRiO Workstations
Quantity	1
Unit Area	94 asf
Area	94 asf
Occupancy	B
Occupants	14
Description	TRiO Workstations
Uses	Study, Writing Center
Adjacencies	Student Success Center, SS Offices
Furniture	Chairs, carrel tables
Moveable Equipment	Movable whiteboards, glass boards
Fixed Equipment	N/A
Doors	N/A
Windows	N/A
Floor	Carpet tile
Walls	Gypsum board, low VOC paint, sound batt insulation, wall protection
Ceiling	Grid / ACT
Acoustics	High NRC: 0.80 minimum
HVAC	LEED – independent zone
Plumbing	None
Power	110 V, 20 amp
Lighting	LED
Audio/Visual	None
Data	Data outlets, wireless
Telephone	None
Security	N/A
Life Safety	NFPA fire sprinkler
Environmental Quality	Low-Emitting Materials

Space Number	3.14
Space Name	Student Success Center Storage
Quantity	1
Unit Area	44 asf
Area	44 asf
Occupancy	B
Occupants	N/A
Description	Student Success Center Storage
Uses	Storage
Adjacencies	Student Success Center, SS Offices
Furniture	N/A
Moveable Equipment	N/A
Fixed Equipment	N/A
Doors	Lockset reader
Windows	Insulated, low e-glazing, window film
Floor	Resilient flooring
Walls	Gypsum board, low VOC paint, sound batt insulation, wall protection
Ceiling	Grid / ACT
Acoustics	STC: 35
HVAC	LEED – independent zone
Plumbing	None
Power	110 V, 20 amp
Lighting	LED
Audio/Visual	None
Data	Wireless
Telephone	None
Security	N/A
Life Safety	NFPA fire sprinkler
Environmental Quality	Low-Emitting Materials

Space Number	3.15
Space Name	Testing Center Director Office
Quantity	1
Unit Area	165 asf
Area	165 asf
Occupancy	B
Occupants	1
Description	Testing Center Director Office
Uses	Office
Adjacencies	Testing Center, Student Success Center
Furniture	Chairs, desk, filing cabinets, bookcases, whiteboards
Moveable Equipment	Computer, monitor
Fixed Equipment	Lockers
Doors	Lockset reader, glazing (narrow lite)
Windows	Shades, window film (can opt to proctor)
Floor	Carpet tile
Walls	Gypsum board, low VOC paint, sound batt insulation
Ceiling	Grid / ACT
Acoustics	STC: 50; CAC: 35 min. / NRC: 0.65 min.
HVAC	LEED – independent zone
Plumbing	None
Power	110 V, 20 amp
Lighting	LED
Audio/Visual	TBD
Data	Data outlets, wireless
Telephone	Yes
Security	Lockset reader, surveillance cameras
Life Safety	NFPA fire sprinkler
Environmental Quality	Low-Emitting Materials, Lighting Controls

Space Number	3.16
Space Name	Testing Center Check-in / Wait Area
Quantity	1
Unit Area	241 asf
Area	241 asf
Occupancy	B
Occupants	1 student station + waiting room
Description	Testing Center Check-in / Wait Area
Uses	Office
Adjacencies	Testing Center, Student Success Center
Furniture	Chairs, desk, filing cabinets, bookcases, whiteboards
Moveable Equipment	Computer, monitor
Fixed Equipment	Lockers
Doors	Lockset reader, glazing (narrow lite)
Windows	Shades, window film
Floor	Carpet tile
Walls	Gypsum board, low VOC paint, sound batt insulation
Ceiling	Grid / ACT
Acoustics	STC: 50; CAC: 35 min. / NRC: 0.65 min.
HVAC	LEED – independent zone
Plumbing	None
Power	110 V, 20 amp
Lighting	LED
Audio/Visual	TBD
Data	Data outlets, wireless
Telephone	Yes
Security	Lockset reader, surveillance cameras
Life Safety	NFPA fire sprinkler
Environmental Quality	Low-Emitting Materials, Lighting Controls

Space Number	3.17
Space Name	Business Incubator
Quantity	1
Unit Area	316 asf (net)
Area	532 asf (gross) – includes 2 Huddle Rooms
Occupancy	B
Occupants	8 – 12 (gross)
Description	Business Incubator
Uses	Office and Office support, huddle space
Adjacencies	Makerspace, Meeting Room
Furniture	Chairs, tables, desks (mobile)
Moveable Equipment	Computers, monitors, copier, other TBD
Fixed Equipment	Casework (lockable), whiteboards, lockers
Doors	Lockset reader, glazing (narrow lite)
Windows	Insulated, low-E glazing, shades
Floor	Carpet tiles
Walls	Gypsum board, low VOC paint, sound batt insulation
Ceiling	Grid / ACT
Acoustics	STC: 45; CAC: 35 min. / NRC: 0.65 min.
HVAC	LEED – independent zone
Plumbing	None
Power	110 V, 20 amps
Lighting	LED overhead, task lighting
Audio/Visual	Monitors
Data	Data outlets, wireless
Telephone	Yes
Security	Lockset reader
Life Safety	NFPA fire sprinkler
Environmental Quality	Low-Emitting Materials, Lighting Controls

Space Number	3.18, 3.19
Space Name	Huddle Room
Quantity	2
Unit Area	103 asf
Area	206 asf
Occupancy	B
Occupants	2
Description	Huddle Room
Uses	Office and Office support, huddle space
Adjacencies	Makerspace, Conference Room
Furniture	Chairs, tables, desks (mobile)
Moveable Equipment	Computer, monitor, copier, other TBD
Fixed Equipment	Casework (lockable), whiteboards, lockers
Doors	Lockset reader, glazing (narrow lite)
Windows	Insulated, low-E glazing, shades
Floor	Carpet tiles
Walls	Gypsum board, low VOC paint, sound batt insulation
Ceiling	Grid / ACT
Acoustics	STC: 45; CAC: 35 min. / NRC: 0.65 min.
HVAC	LEED – independent zone
Plumbing	None
Power	110 V, 20 amps
Lighting	LED overhead, task lighting
Audio/Visual	Monitors
Data	Data outlets, wireless
Telephone	Yes
Security	Lockset reader
Life Safety	NFPA fire sprinkler
Environmental Quality	Low-Emitting Materials, Lighting Controls

Space Number	3.20
Space Name	Faculty Office Suite
Quantity	1
Unit Area	880 asf
Area	880 asf
Occupancy	B
Occupants	7
Description	Faculty Office Suite
Uses	Open Office
Adjacencies	Solution Rooms,
Furniture	Workstation partition systems, chairs, tables, desks, filing cabinets, bookcase, whiteboards
Moveable Equipment	Mini refrigerator, microwave, small coffeemaker
Fixed Equipment	Whiteboards
Doors	Lockset reader, glazing (narrow lite)
Windows	Insulated, low-E glazing, shades
Floor	Carpet tile
Walls	Gypsum board, low VOC paint, sound batt insulation
Ceiling	Grid / ACT
Acoustics	STC: 40; NRC: 0.80 min.
HVAC	LEED – independent zone
Plumbing	
Power	110 V, 20 amp
Lighting	LED
Audio/Visual	TBD
Data	Data outlets, wireless
Telephone	Yes
Security	Lockset reader
Life Safety	NFPA fire sprinkler
Environmental Quality	Low-Emitting Materials, Lighting Controls

Space Number	3.21, 3.22
Space Name	Solution Room
Quantity	2
Unit Area	114 asf
Area	114 asf
Occupancy	B
Occupants	4 - 6
Description	Solution Room
Uses	Conference room
Adjacencies	Faculty Office Suite, Storage
Furniture	Chairs, table
Moveable Equipment	TBD
Fixed Equipment	Whiteboards
Doors	Privacy film
Windows	Privacy film
Floor	Carpet tile
Walls	Gypsum board, low VOC paint, sound batt insulation
Ceiling	Grid / ACT
Acoustics	STC: 40 min.; CAC: 35 min. / NRC: 0.60 min.
HVAC	LEED – independent zone
Plumbing	None
Power	110 V, 20 amp
Lighting	LED
Audio/Visual	TBD
Data	Data outlets, wireless
Telephone	Yes
Security	N/A
Life Safety	NFPA fire sprinkler
Environmental Quality	Low-Emitting Materials, Lighting Controls

Space Number	3.23
Space Name	Faculty Office Suite Storage
Quantity	1
Unit Area	65 asf
Area	65 asf
Occupancy	B
Occupants	N/A
Description	Faculty Office Suite Storage
Uses	Storage
Adjacencies	Faculty Office Suite, Solution Rooms
Furniture	N/A
Moveable Equipment	N/A
Fixed Equipment	N/A
Doors	Lock
Windows	N/A
Floor	Resilient flooring
Walls	Gypsum board, low VOC paint, sound batt insulation
Ceiling	Grid / ACT
Acoustics	N/A
HVAC	LEED – independent zone
Plumbing	None
Power	110 V, 20 amp
Lighting	LED
Audio/Visual	N/A
Data	Wireless
Telephone	No
Security	Lock
Life Safety	NFPA fire sprinkler
Environmental Quality	Low-Emitting Materials, Lighting Controls

Space Number	4.01
Space Name	Research/Resource Collaborative Workroom
Quantity	1
Unit Area	539 asf
Area	539 asf
Occupancy	B
Occupants	8
Description	Research/Resource Collaborative Workroom
Uses	Processing materials, study, storage
Adjacencies	Archivist Office, Archives, Conservation Workroom
Furniture	Chairs, tables, filing cabinets, bookcases
Moveable Equipment	Copier, computer, monitor(s)
Fixed Equipment	Casework, countertops, display boards
Doors	Lockset reader, glazing (narrow lite)
Windows	Insulated, low-E glazing, shades
Floor	Resilient flooring, carpet tile
Walls	Gypsum board, low VOC paint, sound batt insulation
Ceiling	Grid / ACT
Acoustics	CAC: 35 minimum / NRC: 0.65 minimum
HVAC	LEED – independent zone
Plumbing	Sink
Power	110 V, 20 amp
Lighting	LED (overhead), workstation task lighting
Audio/Visual	TBD
Data	Data outlets, wireless
Telephone	Yes
Security	Lockset reader
Life Safety	NFPA fire sprinkler
Environmental Quality	Low-Emitting Materials, Lighting Controls

Space Number	4.02
Space Name	Conservation Workroom
Quantity	1
Unit Area	380 asf
Area	380 asf
Occupancy	B
Occupants	4
Description	Conservation Workroom
Uses	Repairs, binding, storage
Adjacencies	Archivist Office, Archives, Research/Resource
Furniture	Chairs, tables, filing cabinets, bookcases
Moveable Equipment	Paper cutter, comb bind machine, copier
Fixed Equipment	Casework, countertops, whiteboards, bulletin boards
Doors	Lockset reader, glazing (narrow lite)
Windows	N/A
Floor	Resilient flooring, carpet tile
Walls	Gypsum board, low VOC paint, sound batt insulation
Ceiling	Grid / ACT
Acoustics	CAC: 35 minimum / NRC: 0.65 minimum
HVAC	LEED – independent zone
Plumbing	Sink
Power	110 V, 20 amp
Lighting	LED (overhead), workstation task lighting
Audio/Visual	TBD
Data	Data outlets, wireless
Telephone	Yes
Security	Lockset reader
Life Safety	NFPA fire sprinkler
Environmental Quality	Low-Emitting Materials, Lighting Controls

Space Number	4.03
Space Name	Archives
Quantity	1
Unit Area	1075 asf
Area	1075 asf
Occupancy	A-3
Occupants	10
Description	Archives
Uses	Stacks, storage
Adjacencies	Circulation, Library Coordinator/Director Office, Library Workroom
Furniture	Chairs, tables, filing cabinets, bookcases
Moveable Equipment	TBD
Fixed Equipment	Casework, countertops, whiteboards, bulletin boards
Doors	Lockset reader, glazing (narrow lite)
Windows	N/A
Floor	Resilient flooring
Walls	Gypsum board, low VOC paint, sound batt insulation
Ceiling	Grid / ACT
Acoustics	CAC: 35 minimum / NRC: 0.65 minimum
HVAC	LEED – independent zone
Plumbing	Sink
Power	110 V, 20 amp
Lighting	LED (overhead), workstation task lighting
Audio/Visual	TBD
Data	Data outlets, wireless
Telephone	Yes
Security	Lockset reader
Life Safety	NFPA fire sprinkler
Environmental Quality	Low-Emitting Materials, Lighting Controls

Space Number	4.04
Space Name	Library Collection
Quantity	1
Unit Area	1849 asf
Area	1849 asf
Occupancy	A-3
Occupants	18
Description	Library Collection
Uses	Stacks, Open Stack Study Room
Adjacencies	Circulation, Library Coordinator/Director Office, Library Workroom
Furniture	Chairs, tables, filing cabinets, bookcases
Moveable Equipment	Copier(s)
Fixed Equipment	Casework, countertops, whiteboards, bulletin boards
Doors	Lockset reader, glazing (narrow lite), secured overhead grille door
Windows	N/A
Floor	Carpet tile
Walls	Gypsum board, low VOC paint, sound batt insulation
Ceiling	Grid / ACT
Acoustics	CAC: 35 minimum / NRC: 0.70 minimum
HVAC	LEED – independent zone
Plumbing	Sink
Power	110 V, 20 amp
Lighting	LED (overhead), workstation task lighting
Audio/Visual	TBD
Data	Data outlets, wireless
Telephone	None
Security	Lockset reader
Life Safety	NFPA fire sprinkler
Environmental Quality	Low-Emitting Materials, Lighting Controls

Space Number	4.05
Space Name	Library Circulation
Quantity	1
Unit Area	260 asf
Area	260 asf
Occupancy	B
Occupants	4
Description	Library Circulation
Uses	Service, processing
Adjacencies	Collection, Library Coordinator/Director Office, Library Workroom
Furniture	Chairs, tables, filing cabinets, bookcases
Moveable Equipment	Self-serve kiosk, computers, monitors, printer
Fixed Equipment	Casework, countertops, whiteboards, bulletin boards
Doors	Lockset reader, overhead grille door
Windows	N/A
Floor	Carpet tile
Walls	Gypsum board, low VOC paint, sound batt insulation
Ceiling	Grid / ACT
Acoustics	CAC: 35 minimum / NRC: 0.65 minimum
HVAC	LEED – independent zone
Plumbing	None
Power	110 V, 20 amp
Lighting	LED (overhead), workstation task lighting
Audio/Visual	Visual Monitor
Data	Data outlets, wireless
Telephone	Yes
Security	Lockset reader
Life Safety	NFPA fire sprinkler
Environmental Quality	Low-Emitting Materials, Lighting Controls

Space Number	4.06
Space Name	Library Workroom
Quantity	1
Unit Area	372 asf
Area	372 asf
Occupancy	B
Occupants	4
Description	Library Workroom
Uses	Processing, repair, storage
Adjacencies	Circulation, Library Coordinator/Director Office, Library Collection
Furniture	Chairs, tables, filing cabinets, bookcases
Moveable Equipment	Computer, printer, paper cutter, comb bind machine
Fixed Equipment	Casework, countertops, whiteboards, bulletin boards
Doors	Lockset reader, glazing (narrow lite)
Windows	N/A
Floor	Resilient flooring
Walls	Gypsum board, low VOC paint, sound batt insulation
Ceiling	Grid / ACT
Acoustics	CAC: 35 minimum / NRC: 0.65 minimum
HVAC	LEED – independent zone
Plumbing	Sink
Power	110 V, 20 amp
Lighting	LED (overhead), workstation task lighting
Audio/Visual	TBD
Data	Data outlets, wireless
Telephone	Yes
Security	Lockset reader
Life Safety	NFPA fire sprinkler
Environmental Quality	Low-Emitting Materials, Lighting Controls

Space Number	4.07
Space Name	Library Storage
Quantity	1
Unit Area	61 asf
Area	61 asf
Occupancy	B
Occupants	N/A
Description	Library Storage
Uses	Storage
Adjacencies	Library Workroom, Library Coord./Director Office
Furniture	N/A
Moveable Equipment	TBD
Fixed Equipment	N/A
Doors	Lock
Windows	N/A
Floor	Resilient flooring
Walls	Gypsum board, low VOC paint, sound batt insulation, guardrail
Ceiling	Grid / ACT
Acoustics	CAC: 0.35 min. / NRC: 0.60 min.
HVAC	LEED – independent zone
Plumbing	None
Power	110 V, 20 amp
Lighting	LED
Audio/Visual	None
Data	Wireless
Telephone	None
Security	N/A
Life Safety	NFPA fire sprinkler
Environmental Quality	Low-Emitting Materials

Space Number	4.08
Space Name	Media Room
Quantity	1
Unit Area	43 asf
Area	174 asf
Occupancy	B
Occupants	4
Description	Media Room
Uses	Media collection – DVD, audio media
Adjacencies	Listening Room, Circulation, Library Coordinator/Director Office, Library Collection
Furniture	Chairs, carrel tables, bookcases
Moveable Equipment	Computers, monitors
Fixed Equipment	White boards
Doors	Lockset reader, glazing (narrow lite)
Windows	Existing corridor
Floor	Carpet tile
Walls	Gypsum board, low VOC paint, sound batt insulation
Ceiling	Grid / ACT
Acoustics	CAC: 35 minimum / NRC: 0.65 minimum
HVAC	LEED – independent zone
Plumbing	None
Power	110 V, 20 amp
Lighting	LED (overhead), workstation task lighting
Audio/Visual	TBD
Data	Data outlets, wireless
Telephone	N/A
Security	Lockset reader
Life Safety	NFPA fire sprinkler
Environmental Quality	Low-Emitting Materials, Lighting Controls

Space Number	4.09
Space Name	Listening Room
Quantity	1
Unit Area	67 asf
Area	67 asf
Occupancy	B
Occupants	1
Description	Listening Room
Uses	Listening to vinyl and early shellac records
Adjacencies	Media Room, Circulation, Library Coordinator/Director Office, Library Collection
Furniture	Chair, tables
Moveable Equipment	Record player, tape player
Fixed Equipment	Speakers, acoustic panels
Doors	Narrow lite, door seals
Windows	Sidelite, sealed around opening, window film
Floor	Carpet tile
Walls	Gypsum board, low VOC paint, sound batt insulation
Ceiling	Grid / ACT
Acoustics	STC: 40; CAC: 35 min. / NRC: 0.65 min.
HVAC	LEED – independent zone
Plumbing	None
Power	110 V, 20 amp
Lighting	LED (overhead)
Audio/Visual	TBD
Data	Data outlets, wireless
Telephone	N/A
Security	Surveillance camera
Life Safety	NFPA fire sprinkler
Environmental Quality	Low-Emitting Materials, Lighting Controls

Space Number	4.10
Space Name	Study Lounge
Quantity	1
Unit Area	2159 asf
Area	2159 asf
Occupancy	A-3
Occupants	72 for reading room; 144 for large assemblies
Description	Study lounge
Uses	Study Hall, individual study, group study; special events for large assemblies
Adjacencies	Storage, Student Success Center, Restrooms, Security, Library services, Study Mezzanine
Furniture	Chairs, tables
Moveable Equipment	TBD
Fixed Equipment	Speakers
Doors	Lock, alarm for new exterior exit door, secured overhead grille door
Windows	Insulated, low-e glass
Floor	Carpet tile
Walls	Gypsum board, low VOC paint, sound batt insulation, guardrail
Ceiling	Grid / ACT
Acoustics	CAC: 0.35 min. / NRC: 0.80 min.
HVAC	LEED – independent zone
Plumbing	None
Power	110 V, 20 amp, floor outlets
Lighting	LED, featured suspended fixtures
Audio/Visual	Speakers, video monitors
Data	Data outlets, wireless
Telephone	Yes
Security	Door alarm, surveillance cameras (interior & ext.)
Life Safety	NFPA fire sprinkler
Environmental Quality	Low-Emitting Materials

Space Number	4.11
Space Name	Study Lounge Storage
Quantity	1
Unit Area	69 asf
Area	69 asf
Occupancy	B
Occupants	N/A
Description	Study Lounge Storage
Uses	Table and chair storage
Adjacencies	Study Lounge
Furniture	N/A
Moveable Equipment	N/A
Fixed Equipment	N/A
Doors	Lockset reader
Windows	N/A
Floor	Resilient flooring
Walls	Gypsum board, low VOC paint, sound batt insulation, wall protection
Ceiling	Grid / ACT
Acoustics	N/A
HVAC	LEED – independent zone
Plumbing	None
Power	110 V, 20 amp
Lighting	LED
Audio/Visual	None
Data	Wireless
Telephone	None
Security	N/A
Life Safety	NFPA fire sprinkler
Environmental Quality	Low-Emitting Materials

Space Number	4.12
Space Name	Study Room
Quantity	1
Unit Area	130 asf
Area	130 asf
Occupancy	B
Occupants	N/A
Description	Study Room
Uses	Individual study, group study
Adjacencies	Classrooms, Study Rooms
Furniture	Chairs, table
Moveable Equipment	N/A
Fixed Equipment	Whiteboards
Doors	Glass sliding door, window film
Windows	N/A
Floor	Carpet tile
Walls	Gypsum board, low VOC paint, sound batt insulation
Ceiling	Grid / ACT
Acoustics	STC: 40 min.; CAC: 0.35 min. / NRC: 0.65 min.
HVAC	LEED – independent zone
Plumbing	None
Power	110 V, 20 amp
Lighting	LED
Audio/Visual	None
Data	Wireless
Telephone	None
Security	N/A
Life Safety	NFPA fire sprinkler
Environmental Quality	Low-Emitting Materials

Space Number	4.13
Space Name	Study Room
Quantity	1
Unit Area	130 asf
Area	130 asf
Occupancy	B
Occupants	6 - 8
Description	Study Room
Uses	Individual study, group study
Adjacencies	Classrooms, Study Rooms
Furniture	Chairs, table
Moveable Equipment	N/A
Fixed Equipment	Whiteboards
Doors	Glass sliding door, window film
Windows	N/A
Floor	Carpet tile
Walls	Gypsum board, low VOC paint, sound batt insulation
Ceiling	Grid / ACT
Acoustics	STC: 40 min.; CAC: 0.35 min. / NRC: 0.65 min.
HVAC	LEED – independent zone
Plumbing	None
Power	110 V, 20 amp
Lighting	LED
Audio/Visual	None
Data	Wireless
Telephone	None
Security	N/A
Life Safety	NFPA fire sprinkler
Environmental Quality	Low-Emitting Materials

Space Number	4.14
Space Name	Study Room
Quantity	1
Unit Area	100 asf
Area	100 asf
Occupancy	B
Occupants	4 - 6
Description	Study Room
Uses	Individual study, group study
Adjacencies	Classrooms, Study Rooms
Furniture	Chairs, table
Moveable Equipment	N/A
Fixed Equipment	Whiteboards
Doors	Glass sliding door, window film
Windows	N/A
Floor	Carpet tile
Walls	Gypsum board, low VOC paint, sound batt insulation
Ceiling	Grid / ACT
Acoustics	STC: 40 min.; CAC: 0.35 min. / NRC: 0.65 min.
HVAC	LEED – independent zone
Plumbing	None
Power	110 V, 20 amp
Lighting	LED
Audio/Visual	None
Data	Wireless
Telephone	None
Security	NA
Life Safety	NFPA fire sprinkler
Environmental Quality	Low-Emitting Materials

Space Number	4.15
Space Name	Study Room
Quantity	1
Unit Area	100 asf
Area	100 asf
Occupancy	B
Occupants	4 - 6
Description	Study Room
Uses	Individual study, group study
Adjacencies	Classrooms, Study Rooms
Furniture	Chairs, table
Moveable Equipment	N/A
Fixed Equipment	Whiteboards
Doors	Glass sliding door, window film
Windows	N/A
Floor	Carpet tile
Walls	Gypsum board, low VOC paint, sound batt insulation
Ceiling	Grid / ACT
Acoustics	STC: 40 min.; CAC: 0.35 min. / NRC: 0.65 min.
HVAC	LEED – independent zone
Plumbing	None
Power	110 V, 20 amp
Lighting	LED
Audio/Visual	None
Data	Wireless
Telephone	None
Security	NA
Life Safety	NFPA fire sprinkler
Environmental Quality	Low-Emitting Materials

Space Number	4.16
Space Name	Study Room
Quantity	1
Unit Area	130 asf
Area	130 asf
Occupancy	B
Occupants	4 - 6
Description	Study Room
Uses	Individual study, group study
Adjacencies	Classrooms, Study Rooms
Furniture	Chairs, table
Moveable Equipment	N/A
Fixed Equipment	Whiteboards
Doors	Glass sliding door, window film
Windows	N/A
Floor	Carpet tile
Walls	Gypsum board, low VOC paint, sound batt insulation
Ceiling	Grid / ACT
Acoustics	STC: 40 min.; CAC: 0.35 min. / NRC: 0.65 min.
HVAC	LEED – independent zone
Plumbing	None
Power	110 V, 20 amp
Lighting	LED
Audio/Visual	None
Data	Wireless
Telephone	None
Security	N/A
Life Safety	NFPA fire sprinkler
Environmental Quality	Low-Emitting Materials

Space Number	4.17
Space Name	Study Room
Quantity	1
Unit Area	130 asf
Area	130 asf
Occupancy	B
Occupants	6 - 8
Description	Study Room
Uses	Individual study, group study
Adjacencies	Classrooms, Study Rooms
Furniture	Chairs, table
Moveable Equipment	None
Fixed Equipment	Whiteboards
Doors	Glass sliding door, window film
Windows	N/A
Floor	Carpet tile
Walls	Gypsum board, low VOC paint, sound batt insulation
Ceiling	Grid / ACT
Acoustics	STC: 40 min.; CAC: 0.35 min. / NRC: 0.65 min.
HVAC	LEED – independent zone
Plumbing	None
Power	110 V, 20 amp
Lighting	LED
Audio/Visual	None
Data	Wireless
Telephone	None
Security	N/A
Life Safety	NFPA fire sprinkler
Environmental Quality	Low-Emitting Materials

Space Number	4.18
Space Name	Study Lounge
Quantity	1
Unit Area	176 asf
Area	176 asf
Occupancy	B
Occupants	12
Description	Study Lounge – mezzanine, open area
Uses	Individual study, group study
Adjacencies	Classrooms, Restrooms
Furniture	Chairs, tables
Moveable Equipment	None
Fixed Equipment	Whiteboards
Doors	N/A
Windows	N/A
Floor	Carpet tile
Walls	Gypsum board, low VOC paint, sound batt insulation, guardrail
Ceiling	Grid / ACT
Acoustics	STC: 40 min.; CAC: 0.35 min. / NRC: 0.80 min.
HVAC	LEED – independent zone
Plumbing	None
Power	110 V, 20 amp
Lighting	LED
Audio/Visual	None
Data	Wireless
Telephone	None
Security	N/A
Life Safety	NFPA fire sprinkler
Environmental Quality	Low-Emitting Materials

Space Number	6.01
Space Name	Gallery Lounge
Quantity	1
Unit Area	1371 asf
Area	1371 asf
Occupancy	A-3
Occupants	46
Description	Gallery lounge
Uses	Exhibit space, lounge area
Adjacencies	Exterior courtyard, Main Entry, Security Office, Library services, Study Lounge
Furniture	Chairs, tables
Moveable Equipment	None
Fixed Equipment	Fireplace
Doors	Lockset readers, alarm
Windows	Insulated, low-e glass, shades
Floor	Carpet tile
Walls	Gypsum board, low VOC paint, sound batt insulation, guardrail
Ceiling	Grid / ACT
Acoustics	CAC: 0.35 min. / NRC: 0.80 min.
HVAC	LEED – independent zone
Plumbing	None
Power	110 V, 20 amp
Lighting	LED, feature lighting
Audio/Visual	TBD
Data	Wireless
Telephone	None
Security	Surveillance cameras
Life Safety	NFPA fire sprinkler
Environmental Quality	Low-Emitting Materials

Space Number	6.02
Space Name	Meeting Room
Quantity	1
Unit Area	398 asf
Area	398 asf
Occupancy	B
Occupants	16
Description	Meeting Room
Uses	Meetings; videoconferencing; can supplement Makerspace or Business Incubator as formal demonstration space
Adjacencies	Business Incubator, Makerspace
Furniture	Chairs, table
Moveable Equipment	Coffee maker
Fixed Equipment	Casework – lockable, projector, projection screen
Doors	Lockset reader
Windows	Insulated, low-E glass, shades; window film
Floor	Carpet tile
Walls	Gypsum board, low VOC paint, sound batt insulation, guardrail
Ceiling	Grid / ACT
Acoustics	CAC: 0.35 min. / NRC: 0.65 min.
HVAC	LEED – independent zone
Plumbing	None
Power	110 V, 20 amp, floor outlet(s)
Lighting	LED
Audio/Visual	Monitors
Data	Cisco Telepresence, data outlets, wireless
Telephone	None
Security	Lockset reader
Life Safety	NFPA fire sprinkler
Environmental Quality	Low-Emitting Materials

Space Number	7.01
Space Name	IDF Closet
Quantity	1
Unit Area	26 asf
Area	26 asf
Occupancy	B
Occupants	1
Description	IDF Closet
Uses	IDF Closet
Adjacencies	Open to Library common space
Furniture	N/A
Moveable Equipment	TBD
Fixed Equipment	IT rack
Doors	Minimum 3'-0" x 7'-0" size, solid core, lockset reader, keyed to IT standards
Windows	Shades
Floor	Static dissipative flooring
Walls	Gypsum board, low VOC paint, acoustic batt insulation
Ceiling	Grid / ACT
Acoustics	CAC: 35 minimum / NRC: 0.65 minimum
HVAC	LEED – independent zone
Plumbing	None
Power	110 V, 20 amp
Lighting	LED
Audio/Visual	None
Data	Data outlets, wireless
Telephone	N/A
Security	Lockset reader
Life Safety	NFPA fire sprinkler, cages for heads
Environmental Quality	Low-Emitting Materials

IV.D. THIRD PARTY REVIEW

- i. The Third Party Review letter will be sent under separate cover.
- ii. Response to Third Party Review letter.