

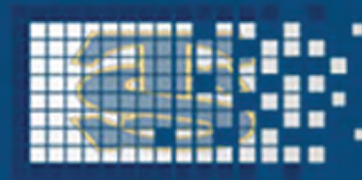

# TRINIDAD STATE PORTAL LOGIN



**Got a question? Check your Portal!**



[Navigate](#)



[My Schedule](#)



[Course Access](#)



[Add/Drop  
Classes](#)



[Look Up  
Classes/Class  
Search](#)



[Final Grades](#)



[Office 365](#)



[Financial Aid  
Requirements](#)



[Financial Aid  
Award](#)



[Pay My Bill](#)



[COF](#)



[Update Personal  
Information](#)



[Transcripts](#)



[Degree Check](#)



[Student Email](#)

## 1. Go to the Trinidad State website:

Click on the TS Connect Portal Login at the bottom of virtually every page on <https://trinidadstate.edu>.

## 2. At the Trinidad State Portal login page:

You will need your S-number.

Your default password will be "StudentMMDDYYYY"

(the word "Student" followed by your date of birth  
if you are a brand new student at Trinidad State)

## 3. Logging in for the first time:

Follow instructions for first-time users.

## 4. YOUR Portal:

When you log in, you'll land on the Dashboard.

Click on the Navigate icon to get started.

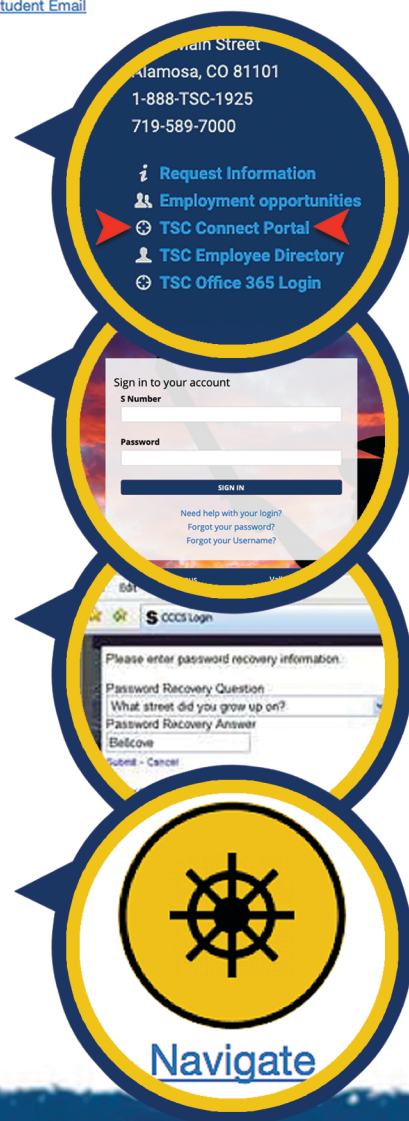

## NEED MORE ASSISTANCE?

Local Support Desk -

Trinidad Campus: (719) 846-5663

Valley Campus: (719) 589-7105

Email support contact -

[Support.Desk@trinidadstate.edu](mailto:Support.Desk@trinidadstate.edu)

After Hours and Weekend Support:

Login help for Student Portal, D2L and CCCOnline  
as well as technical support call 1-888-800-9198.

Having password and login problems?

[https://trinidadstate.edu/login\\_help/](https://trinidadstate.edu/login_help/)